

Shear Beam Type Load Cell

In supreme quality load cell we also offer a Single Beam Load cell SSLC 803 model with different capacity and sizes. This model is capable for tough environmental conditions.

It is suitable for wide weighing applications. We use prime quality stainless steel to construct this load cell.

Wiring Schematic Diagram

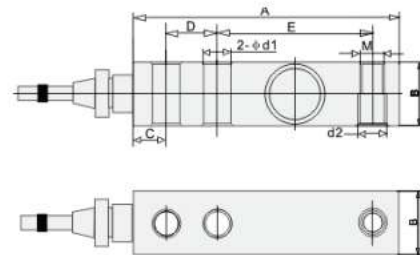
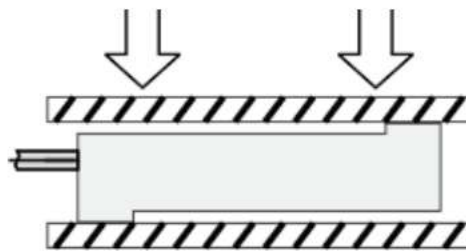
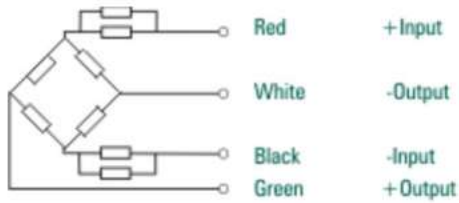

Features:

1. Alloy steel construction and hermetically sealed by welding to IP67 & IP68.
2. Full range of capacities, Low profile design.
3. Simple construction, Standard output for multi-transducer application.
4. Low deflection & creep.

Applications:

1. Industrial automation
2. Electronic platform scale
3. Vehicle scale
4. Railroad scales
5. Tank weighing
6. Hopper weighing etc.

Dimensions:

Rated Load (t)	A	B	C	D	E	M	d2	d1
0.5-2	130	31.8	15.8	25.4	76.2	M12*1.75	19.8	13.5
3T, 5T	171.5	38.1	19.8	38.1	95.3	M18*1.5	19.5	13.51
10T	225.5	50.8	25.3	50.8	124	M24*2	27	27

Specifications :

Related Load (kg.) 100, 200, 300, 500, 750, 1T, 2T, 3T, 5T, 10T	
Precision C3	Insulation Resistance (M Ω) ≥ 5000 (100VDC)
Composition Error ± 0.02	Excitation Voltage (V) 9~12 (DC/AC)
Rated Output (mv/v) 3 ± 0.002	Compensated temp. Range (°C) -10~+40
Non-Linearity (%FS) 0.03 / 0.017	Use Temp. Range (°C) -20~+55
Hysteresis (%FS) 0.03 / 0.02	Temp. Effect on Zero (%FS/10°C) 0.019
Repeatability (%FS) 0.01	Temp. Effect on Span (%FS/10°C) 0.011
Creep (%FS/30min) 0.016	Safe Overload (%FS) 120
Zero Balance (%FS) ± 1	Ultimate Overload (%FS) 150
Input Resistance (Ω) 350 ± 5	Defend Grad IP68
Output Resistance (Ω) 350 ± 3	Cable 4mm, 3mtr

Specifications are subject to change for improvements without prior notice.

